

# FOR LEASE

7029 El Camino Real  
Atascadero, CA



### LEASE Information:

- +/- 11,000 SF
- Asking \$.40 Per SF NNN (NNN estimated at \$.28 Per SF)

### Property Details:

- High Ceilings
- Door High Loading With 8' x 9' Roll Up Door
- Air Conditioned
- Centrally Located
- Ideal Set Up for Dry or Wine Storage

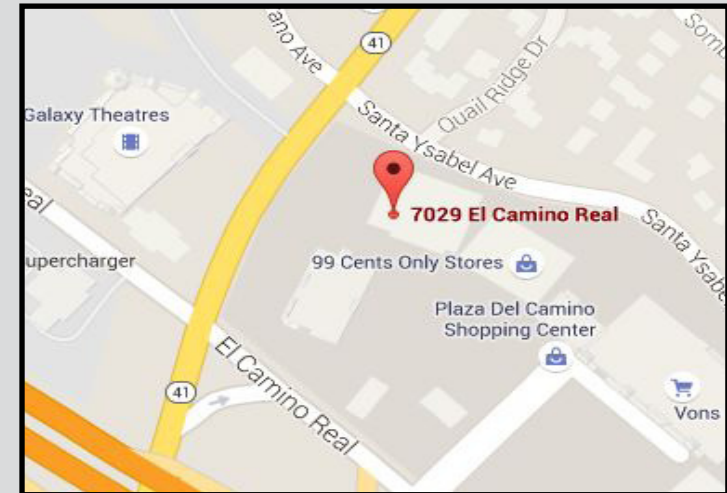

Centrally located warehouse. Ideal set up for dry or wine storage. High ceilings, dock high loading with 8' x 9' roll up door, air conditioned.

Asking **\$.40** per SF (\$4,400.00) NNN (NNN estimated at \$.28 per SF (\$3,080.00)) for a total of **\$7,480.00** per Month

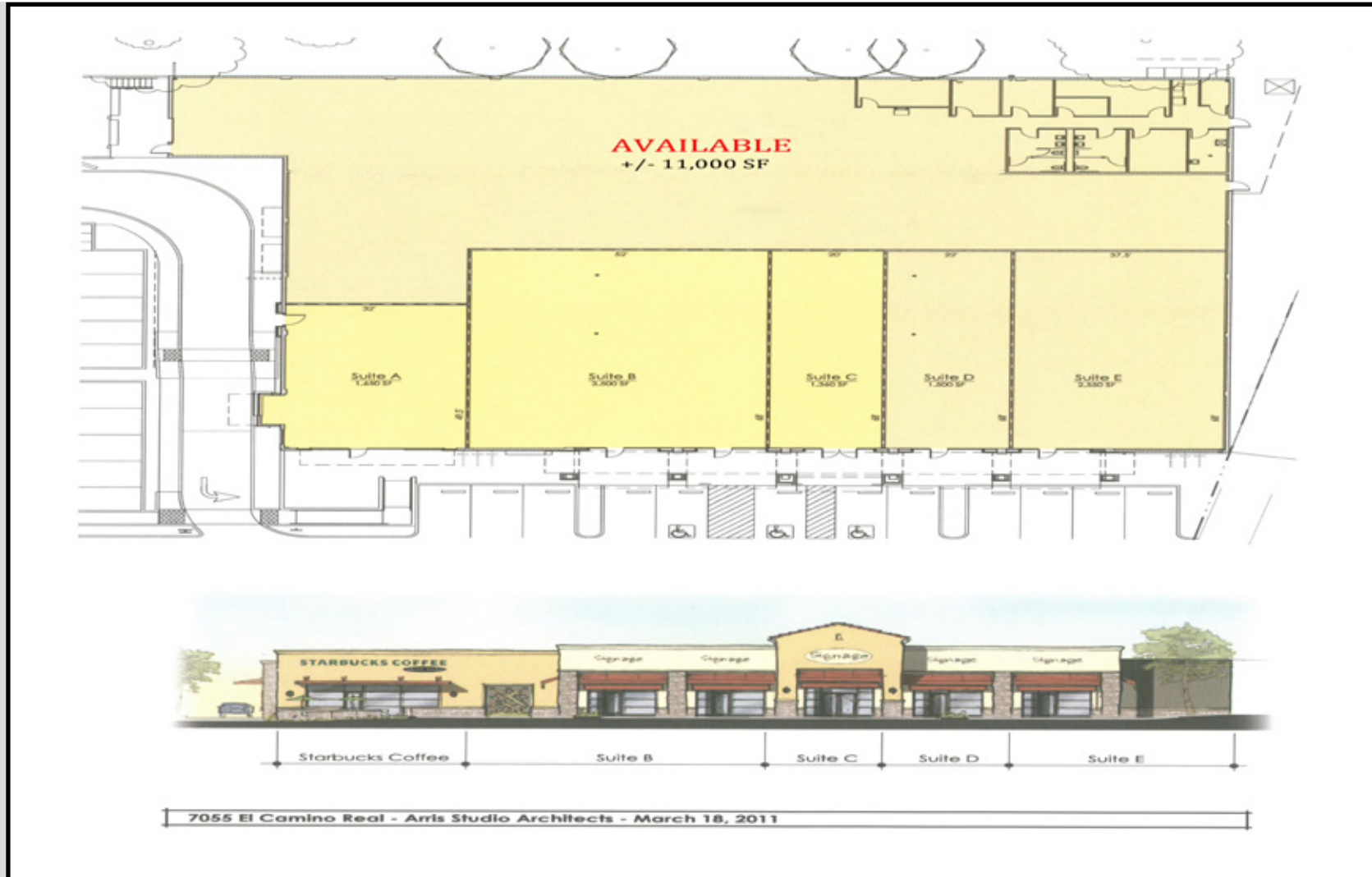



PACIFICA PASO ROBLES  
504 First St, Ste A, Paso Robles, CA 93446  
Office: (805) 237-4040 • Fax: (805) 237-4041  
[www.PacificaPasoRobles.com](http://www.PacificaPasoRobles.com)

**Corban Holland**  
[cholland@pacificarealestate.com](mailto:cholland@pacificarealestate.com)  
BRE#01836854