

Office Space in Industrial Park for Sublease

3230 Riverside Ave. #110
Paso Robles, CA



LEASE Information:

- +/- 2,500 SF
- Asking \$0.95 per SF NNN
- NNN estimated at \$0.08 per SF

Property Details:

- Office space in industrial park
- New paint & carpet throughout
- Zoned for many uses
- Ample on-site parking

+/- 2,500 SF of office space available in Paso Robles Business Park. The property is zoned for many uses. There is new paint and carpet throughout and ample on-site parking.

Asking *only* **\$0.95** per SF NNN
(NNN estimated at \$.08 per sf)

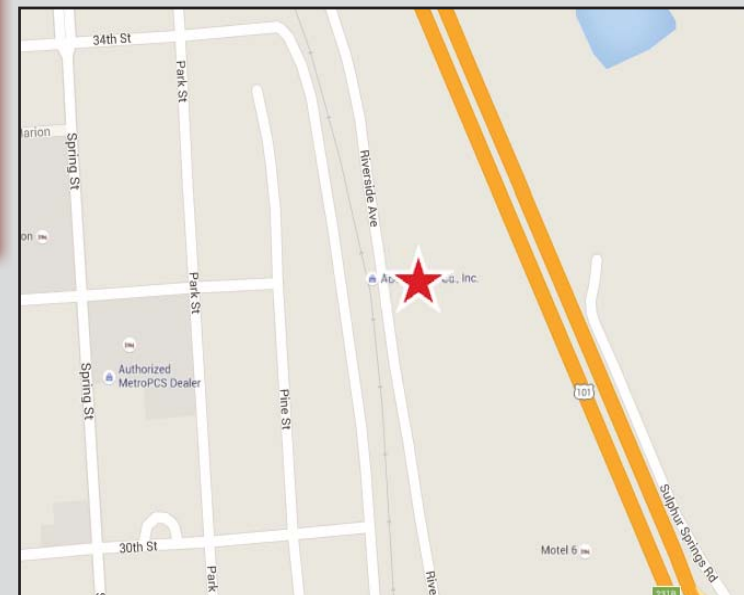

504 First St, Ste A, Paso Robles, CA 93446
Office: (805) 237-4040 • Fax: (805) 237-4041
www.PacificaPasoRobles.com
CalBRE# 01382568

Corban Holland
Office: (805) 237-4040 ext. 241
cholland@pacificarealestate.com
CalBRE# 01836854



