

Highly Visible Commercial Property

1144 Black Oak Dr.
Paso Robles, CA



Building Size: +/- 3,088 Sq.Ft.

Lot Size: +/- 17,859 Sq.Ft

Asking: \$550,000

Lease Rate: \$4,500 per month NNN

Zoning: Riverside Corridor

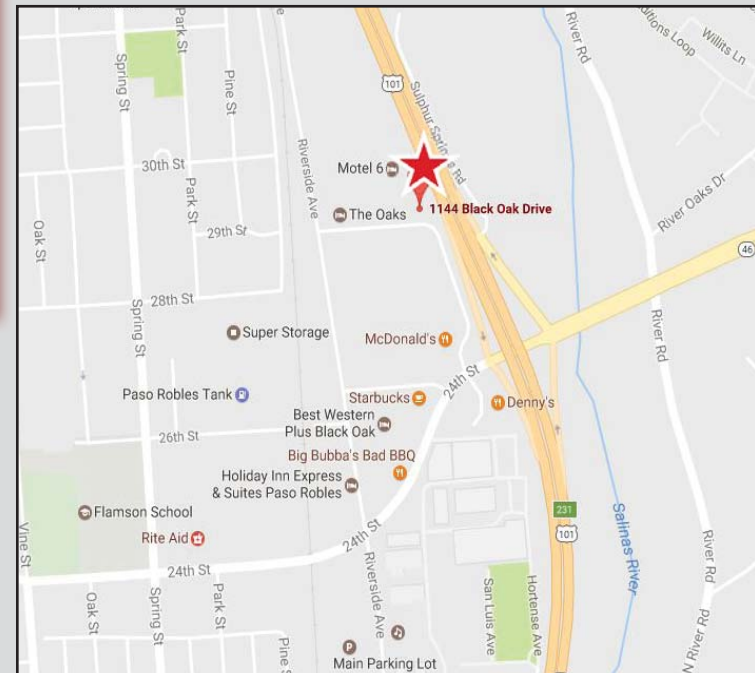

Highly visible commercial income property for sale and lease. Pylon sign visible from US-101, conveniently located near the Hwy 46 E Interchange, Paso Robles Fair Grounds & Event Center and 500 hotel rooms within a 5 minute walk. Numerous upgrades and improvements made over the years. Don't miss this great opportunity!

504 First St, Ste A, Paso Robles, CA 93446
Office: (805) 237-4040 • Fax: (805) 237-4041
www.PacificaPasoRobles.com
CalBRE# 01382568

Corban Holland
Office: (805) 237-4040 ext. 241
corban@pacificacre.com
CalBRE# 01836854

Newlin Hastings
Office: (805) 237-4040 ext. 243
newlin@pacificacre.com
CalBRE# 00784461

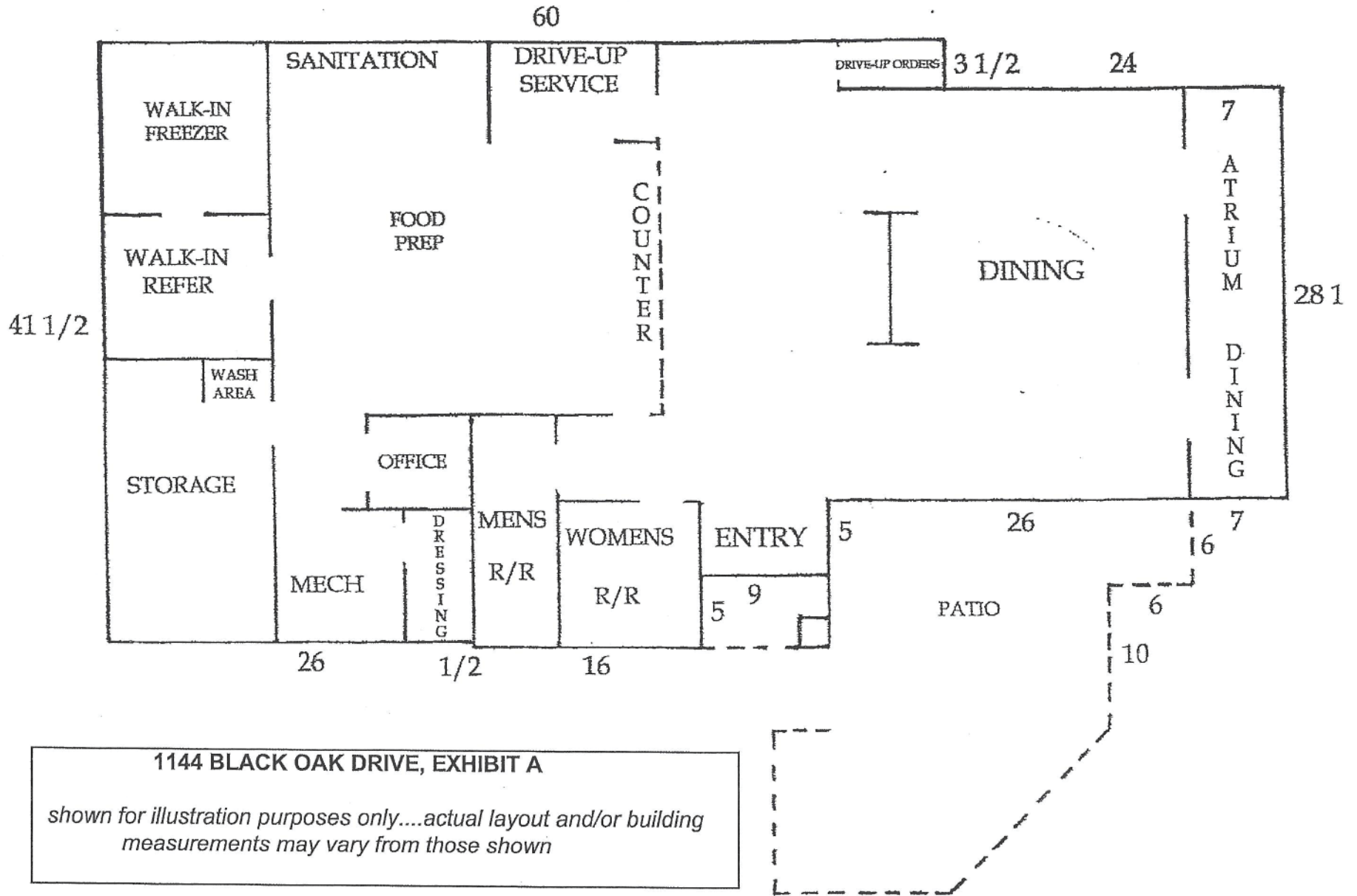



504 First St, Ste A, Paso Robles, CA 93446
Office: (805) 237-4040 • Fax: (805) 237-4041
www.PacificaPasoRobles.com
CalBRE# 01382568

Corban Holland
Office: (805) 237-4040 ext. 241
corban@pacificacre.com
CalBRE# 01836854

Newlin Hastings
Office: (805) 237-4040 ext. 243
newlin@pacificacre.com
CalBRE# 00784461

